

Technology Live!

Styles in Inventor 2013 – 3rd August 2012
Luke Davenport – Industry Specialist

Technology Live!



Agenda:

- 1) **Overview of Changes Made with Materials and Appearances**
- 2) **Workflows for Adding Materials and Appearances to your Models**
- 3) **Do I Need a Specific Procedure for Migrating Materials and Colours from a Previous Release?**

MATERIALS AND COLOURS – WHAT HAPPENED?

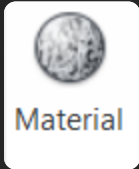

Materials – New Ones Added – Now 2 Standard Libraries to Choose From

- Autodesk Material Library - 275+ Materials (120 Grades of Metal)
- Inventor Material Library – 70+ Materials – (33 Metals – More Generic)

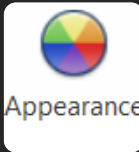

Colours – GONE! – Replaced by Appearances – 3 Standard Libraries to Choose From

- Autodesk Material Library ~ 155 Appearances
- Autodesk Appearance Library ~ 1200 Appearances
- Inventor Material Library ~ 230 Appearances

Note that the Material libraries can contain both Materials and Appearances

1) Materials and Appearances are no longer controlled with the Styles Editor

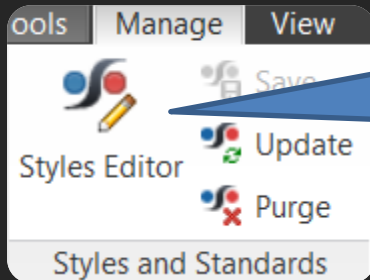

The Styles Editor Now Only contains Lighting Styles in Parts (Drawing Styles are Unchanged)

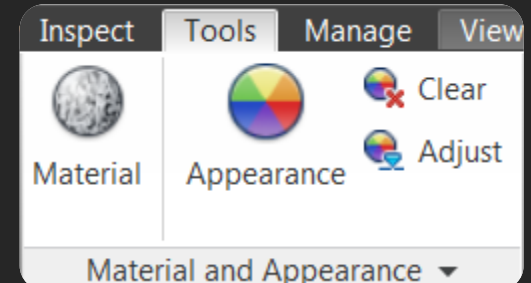

MATERIALS AND COLOURS – WHAT HAPPENED?

2) The Autodesk Materials and Appearance Libraries are **NOT** movable **OR** editable (locked symbols)

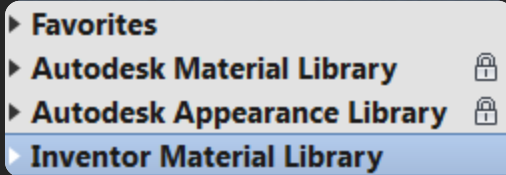

3) The Inventor Material Library is movable and editable ** - *Make sure you set your Default Design Data location in Application options to be in the shared location.*

4) The Libraries Are assigned to (or removed from) Project Files

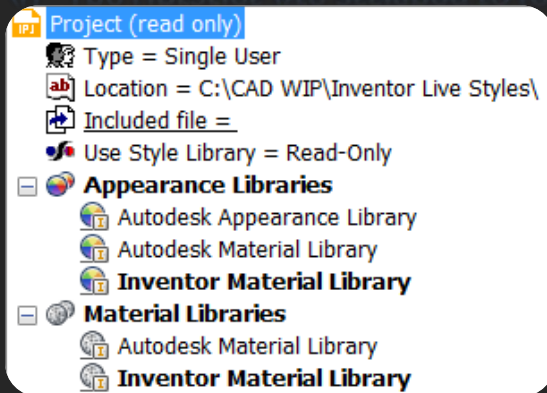

** Currently if any writeable material or appearance library is being accessed by several users you cannot edit or add to it!

5) The (Read/Write) Libraries Can Only Be Edited from the Material or Appearance Browser When a Part or Assembly file is Open.

MATERIALS AND COLOURS – WHAT HAPPENED?

6) Allow much greater ability to customise how your models appear.

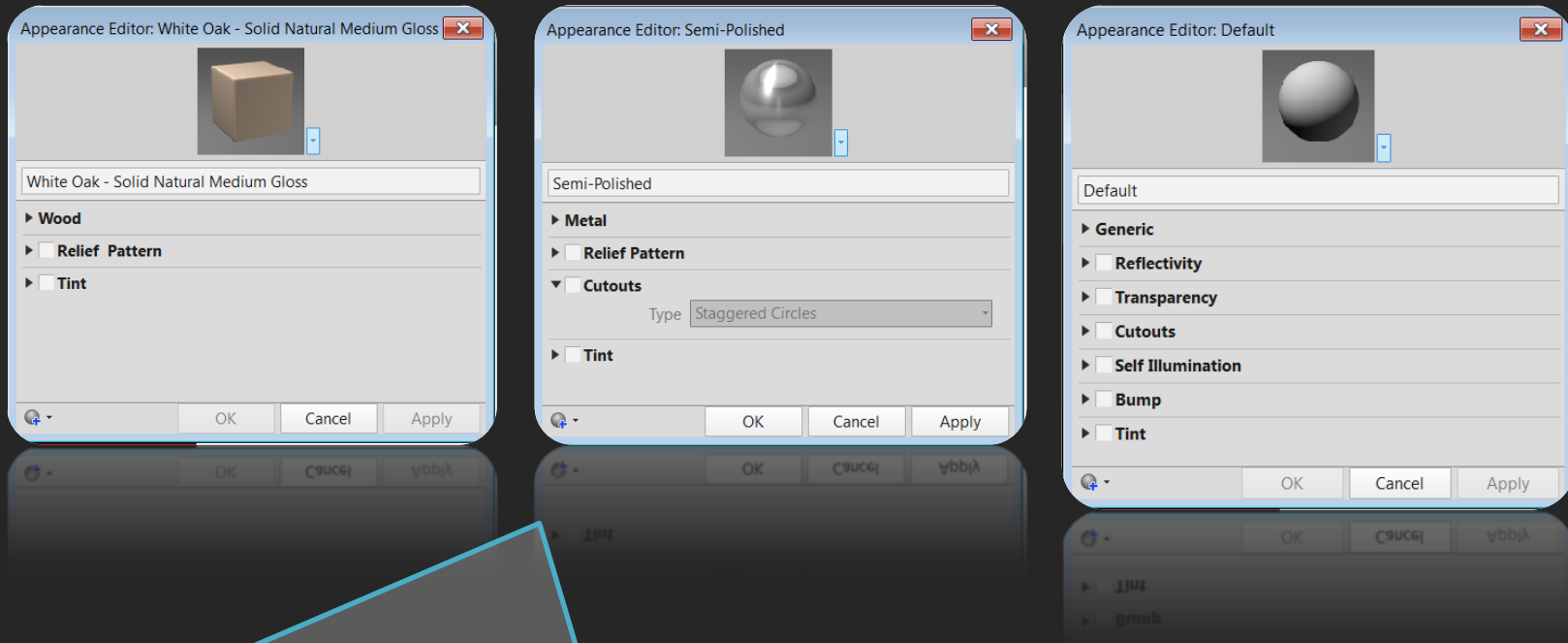

Note the different appearance options available for different categories of material (e.g. cutouts for metal to give a mesh or grid appearance, or stains for wood. Default appearance has the most options although these can lead to confusion!)

MATERIALS AND COLOURS – WHAT HAPPENED?

7) Custom colours from previous releases *DO* require a careful migration process to be followed.

The 'realistic' appearance of your materials in 2012 is a good indication of how they will appear in 2013. If you prefer the normal shaded view appearance (less shiny) then make sure you untick the 'Realistic Appearance' check box for each colour style in 2012 *before* opening in 2013 or migrating using Task Scheduler.

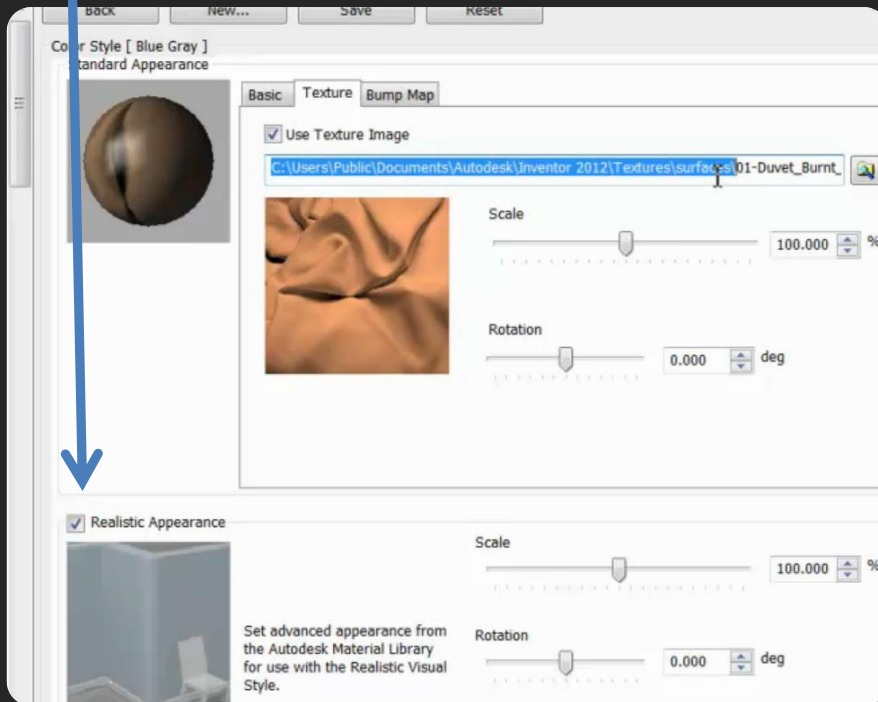

MATERIALS AND COLOURS – WHAT HAPPENED?

- 8) Custom materials from previous releases *DON'T* require a careful migration process to be followed. Autodesk have taken a more conservative approach to Materials than Colours as they may appear in parts lists and therefore shouldn't be overridden.
- 9) Currently libraries are more difficult to manage company-wide compared to 2012

Autodesk have produced a document describing 2 methods of managing a Company-wide Appearance and Materials library. This either involves copying, editing and replacing the library on the server, or modifying the project file and up-versioning the library each time a change needs to be made. This will doubtless be improved in the 2014 release.

WHAT ACTION DO I NEED TO TAKE?

- 1) Remember CADline can assist you with successfully bringing your materials and colours into 2013.
- 2) **Very Important!** - Install Update 1 for Inventor 2013 ([download here](#)) *before* opening or migrating your existing models in Inventor 2013.
- 3) Make sure you create a backup copy of the InventorMaterialLibrary.adsklib file immediately after installation of Inventor 2013.

This is located in the following location: C:\Users\Public\Documents\Autodesk\Inventor 2013\Design Data\Materials

(Some workflows with editing and moving libraries can make this file unstable. If this occurs and you are without a backup, a repair of Inventor will be necessary)

- 4) Consult [this](#) CADline document for a handy install checklist for Inventor 2013 – This also contains a solution for a common migration problem with 2013.
- 5) Consult [this](#) Autodesk document *before* moving to Inventor 2013 if you have created custom company colours and the appearance of these is important for your business.
- 6) Consult [this](#) helpful Autodesk Wiki-help article on managing a company-wide custom material and appearance library in 2013. Note that these methods may very well change for the next release.

click here
to read
my blog

Thank you for your time!

Luke Davenport – Industry Specialist

[CADline Community - Luke Davenport's Blog](#)

