

From / To Cross Reference Signal Display

AutoCAD Electrical 2027

Guide by: Miles Nicholson

AutoCAD Electrical has a variety of cross reference replaceable parameters that can be displayed:

%F	Component family code string (for example, "PB," "SS," "CR," "FLT," "MTR")
%S	Sheet number of the drawing (for example, "01" entered in upper right)
%D	Drawing number
%G	Wire layer name
%N	Sequential or Reference-based number applied to the component
%X	Suffix character position for reference-based tagging (not present = end of tag)
%P	IEC-style project code (default for drawing)
%I	IEC-style installation code (default for drawing)
%L	IEC-style location code (default for drawing)
%A	Project drawing list's SEC value for active drawing
%B	Project drawing list's SUB-SEC value for active drawing

In certain situations, it is helpful to display which component a source signal arrow is connected to, as well as the corresponding component for a destination signal arrow. This functionality is not available in standard AutoCAD Electrical. The ARKANCE AutoCAD Electrical Localiser extends AutoCAD Electrical with additional tools and content aligned with European standards, and the enhanced XREF From/To command is part of these added capabilities.

Select *Electrical* + ribbon > *Wires/Wire Numbers* pane >  *Xref From/To*

The *From* or *To* Component TAG will be displayed in the DESC1 attribute value

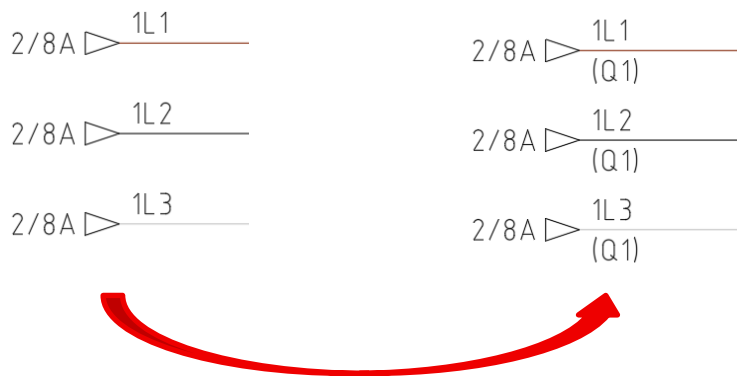

This only updates the current drawing.

To run the command on multiple drawings, you can run the command as a project-wide script.

Select *Project* ribbon > *Project Tools* pane >  *Utilities*

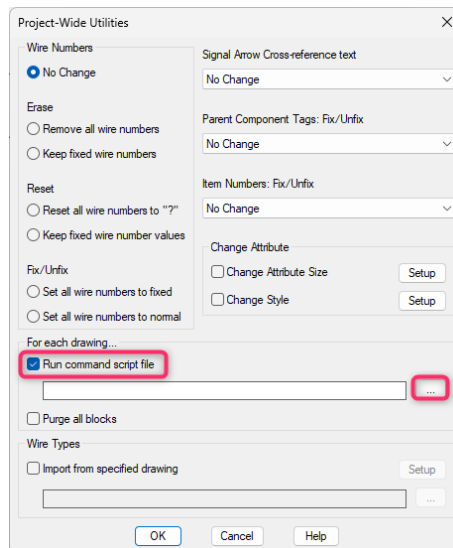

Select *Run command script file*

Select

Create a text file in the default directory with an extension of *.scr

In the text file write a script of and save:

FromTo_Xref

Highlight & select

Select

Select *Project* and then

Select and then